



**Fernleigh Road, Winchmore Hill, London, N21**  
**Offers In Excess Of £850,000 Freehold**

**Anthony Webb**  
ESTATE AGENTS

# Fernleigh Road, Winchmore Hill, London, N21

A chain free original four bedroom Edwardian semi-detached house requiring updating throughout located in a most desirable residential turning with two receptions, morning room, original tiled hallway and a south facing rear garden.

Fernleigh Road is located between Green Lanes and Hoppers Road and is a short walk to Winchmore Hills shops, restaurants, bus routes and mainline station into Moorgate. There are several good schools nearby including St Pauls primary school and Palmers Green high school.

Original stained glass front door • Original tessellated tiled hallway • Two spacious receptions • Morning room with wood burner • Kitchen • Landing with access to loft space with potential to convert • Bathroom with separate w.c • Two good size double bedrooms and two single bedrooms • Partial double glazing • Front garden with original wall • South facing rear garden measuring approx. 60ft.

- Four original bedrooms
- Semi-detached house
- Two receptions
- Morning room and kitchen
- Bathroom/W.C
- In need of updating
- Desirable location
- South facing rear garden





# Fernleigh Road Winchmore Hill London N21 3AJ

Tenure: Freehold  
Gross Internal Area: 1481.00 sq ft



Energy Efficiency Rating		Current	Potential
Very energy efficient - lower running costs			
(92 plus) <b>A</b>			
(81-91) <b>B</b>			
(69-80) <b>C</b>			
(55-68) <b>D</b>			
(39-54) <b>E</b>			
(21-38) <b>F</b>			
(1-20) <b>G</b>			
Not energy efficient - higher running costs			
<b>England &amp; Wales</b>		EU Directive 2002/91/EC	
Environmental Impact (CO <sub>2</sub> ) Rating		Current	Potential
Very environmentally friendly - lower CO <sub>2</sub> emissions			
(92 plus) <b>A</b>			
(81-91) <b>B</b>			
(69-80) <b>C</b>			
(55-68) <b>D</b>			
(39-54) <b>E</b>			
(21-38) <b>F</b>			
(1-20) <b>G</b>			
Not environmentally friendly - higher CO <sub>2</sub> emissions			
<b>England &amp; Wales</b>		EU Directive 2002/91/EC	

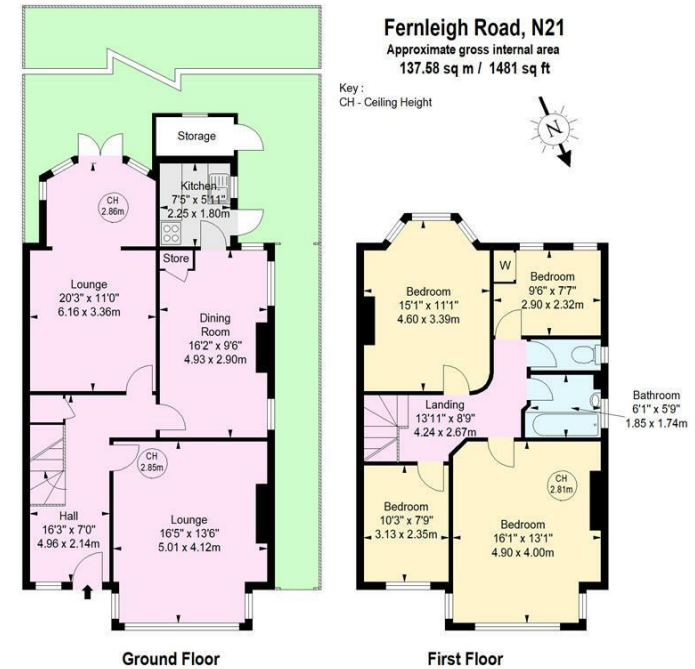

This floor plan is for illustrative purposes only and must not be relied upon as a statement of fact.

Property particulars as supplied by Anthony Webb Estate Agents are set out as a general outline in accordance with the Property Misdescriptions Act (1991) only for the guidance of intending purchasers of lessees, and do not constitute any part of an offer or contract. Details are given without any responsibility, and any intending purchasers, lessees or third parties should not rely on them as inspection or otherwise as to the correctness of each of them. We have not carried out a structural survey and the services, appliances and specific fittings have not been tested. All photographs, measurements, floor plans and distances referred to are given as a guide only and should not be relied upon for the purchase of carpets or any other fixtures statements or representations of fact, but must satisfy themselves by or of fittings, gardens, roof terraces, balconies and communal gardens as well as tenure and lease details cannot have their accuracy guaranteed for intending purchasers. Lease details, service ground rent (where applicable) are given as a guide only and should be checked and confirmed by your solicitor prior to exchange of contracts. no person in the employment of Anthony Webb has any authority to make any representation or warranty whatever in relation to this property.

348 Green Lanes, Palmers Green, London N13 5TJ  
020 8882 7888  
palmersgreen@anthonywebb.co.uk  
anthonywebb.co.uk

**Anthony Webb**  
ESTATE AGENTS